

# CHIEF'S SHOP PLAN OF THE WEEK

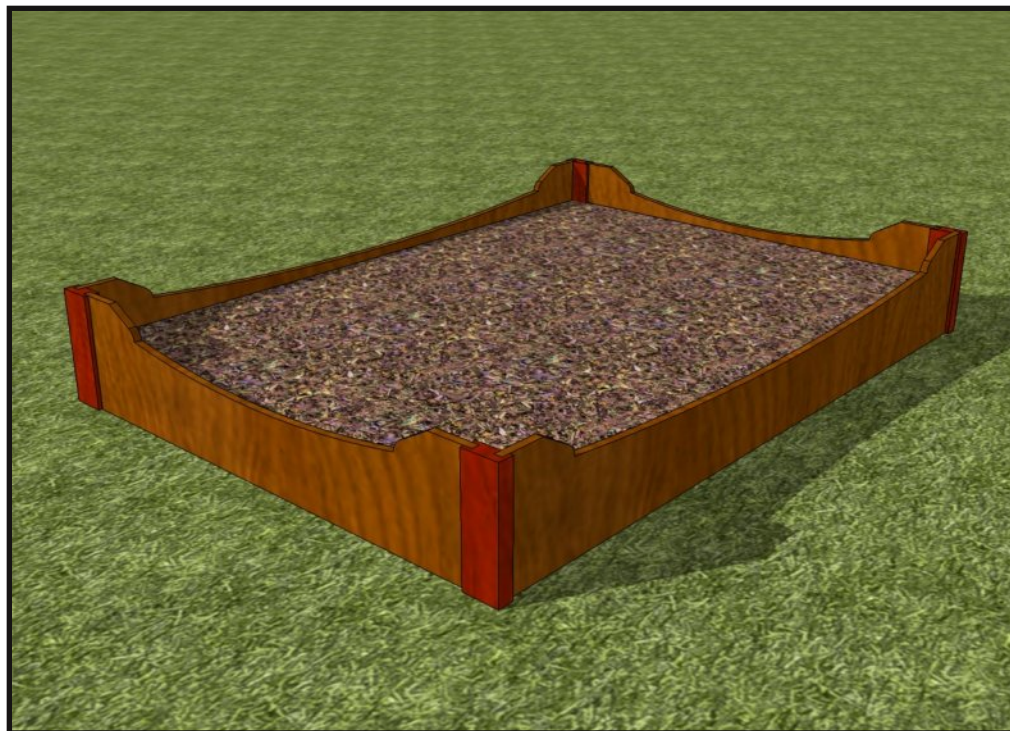

## SIMPLE WOODWORKING: PLANT BED



### WHAT YOU'LL NEED



#### LUMBER

- 2 - 1 x 12 x 8
- 1 - 1 x 12 x 10
- 1 - 2 x 4 x 8

*(availability will vary)*

#### HARDWARE/SUPPLIES

- 1 1/4" deck screws  
(optional)
- timber oil/sealer

#### TOOLS

- table saw w/dado set  
or
- router w/3/4" straight bit
- miter saw/circular saw
- jig saw

### ABOUT THESE PLANS

On this first page you will see above the project complete. On the last page you'll find the finished outer dimensions.

To the right is a list of the Lumber, Hardware/Supplies, and Tools you will need to complete this project. A measuring tape and pencil are not included because that should be pretty standard and self explanatory.

Below What You'll Need is the Parts list. This also is included on the Cutting Diagram page, which is the last page of this plan document.

Throughout these plans you'll find the icons below:



#### LAYOUT

This indicates a diagram detailing the dimensions of a project part and/or the placement for pocket holes, screws, nails, etc.



#### NOTE

Notes are the instructions for a particular step/section of the project.



#### TAKE CARE!

This indicates when to pay close attention to the diagrams, take precautions for safety, etc.

### PARTS

- Posts (4) - 1 1/2 x 3 1/2 x 11 1/4\*
- Ends (2) - 3/4 x 11 1/4 x 73 1/2
- Sides (2) - 3/4 x 11 1/4 x 48 3/4
- \*adjust as desired*

*All parts are listed in actual dimensions. Refer to the Cutting Diagram on the last page of this plan as a guide for determining the specific board from which to cut the parts.*



#### MORE PLANS

Want more Chief's Shop plans? Visit [chiefs-shop.com](http://chiefs-shop.com) and look through the Plans section.

Be sure to "Like" Chief's Shop on facebook by heading over to [facebook.com/ChiefsShop](https://facebook.com/ChiefsShop).

**LAYOUT**

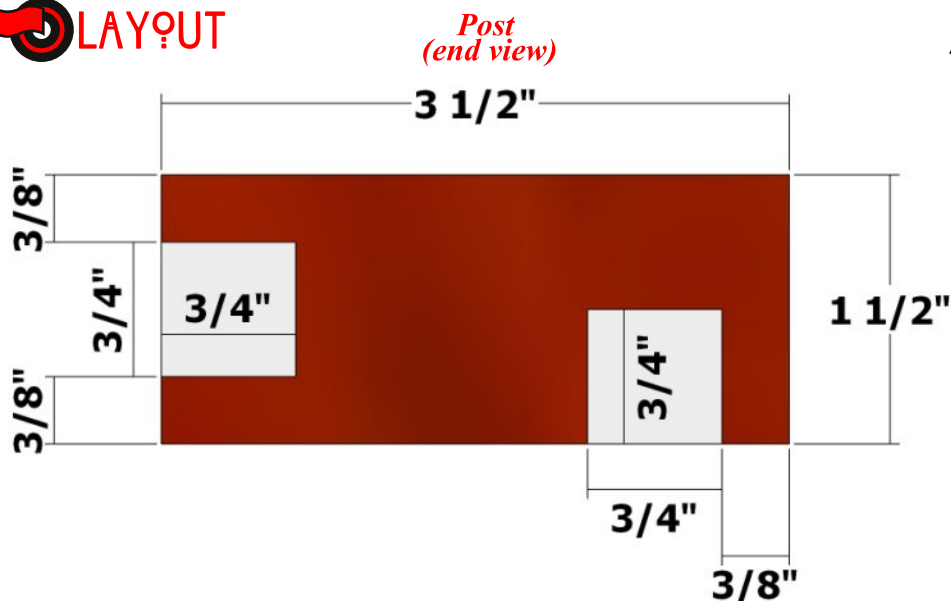

**NOTE**

Use the layout at left as a guide for cutting two grooves in the **Posts**, as shown below. Cut one piece of the 2 x 4 to at least 47 inches, then cut the grooves using either a table saw with dado blade set, or a router with a 3/4-inch straight bit.  
*Note: You will need to make a few passes when cutting out this much material.*

**TAKE CARE!**

If you want to bury the posts, it's recommended that you cut them at least 3 inches longer than the measurement in the cut list.

**NOTE**

Cut the groove on the 3 1/2-inch side first, making several passes of increasing depth the reach a 3/4-inch depth. Use a fence (not shown) as a guide.

**NOTE**

Cut the groove on the 1 1/2-inch side next, making several passes of increasing depth the reach a 3/4-inch depth. Use a fence (not shown) as a guide.

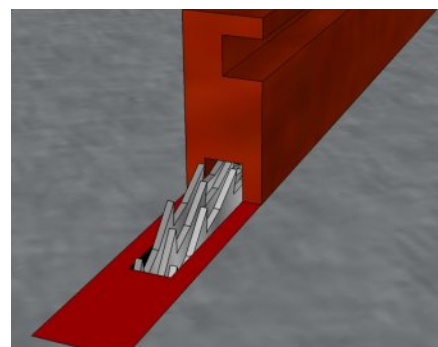
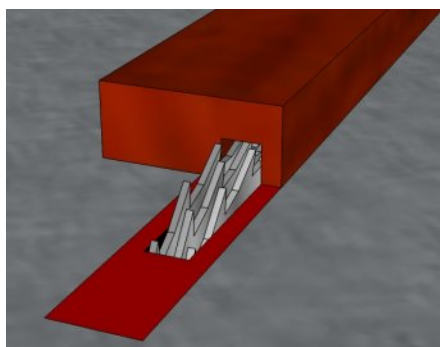
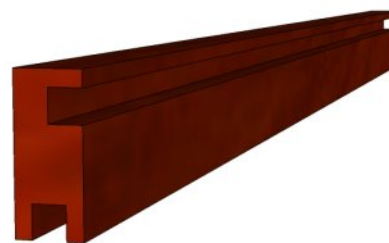
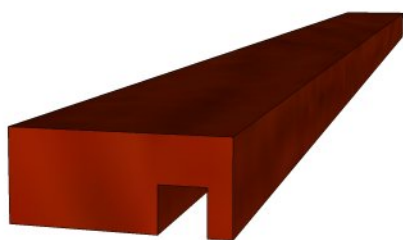

**LAYOUT**

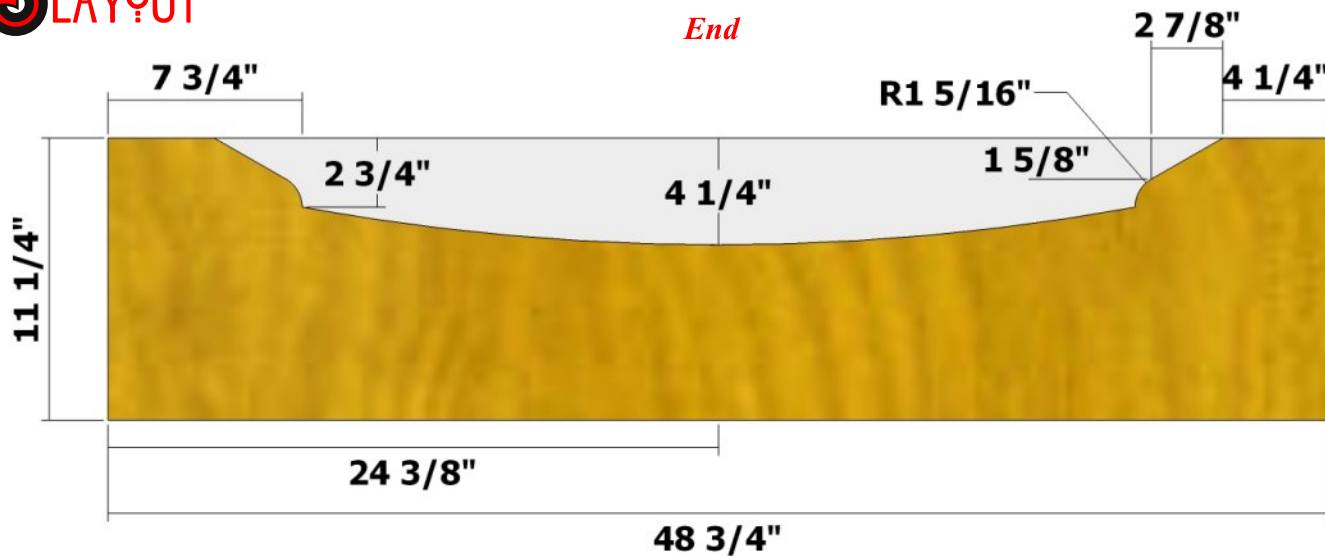

**NOTE**

Use these layouts as guides for measuring, marking, and cutting the Ends and Sides. Create two of each part.

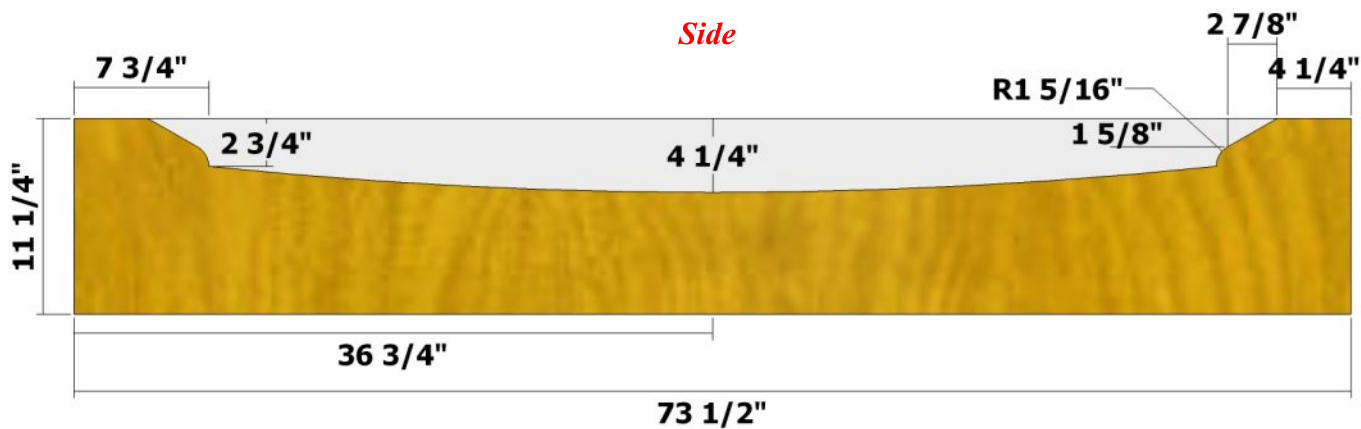

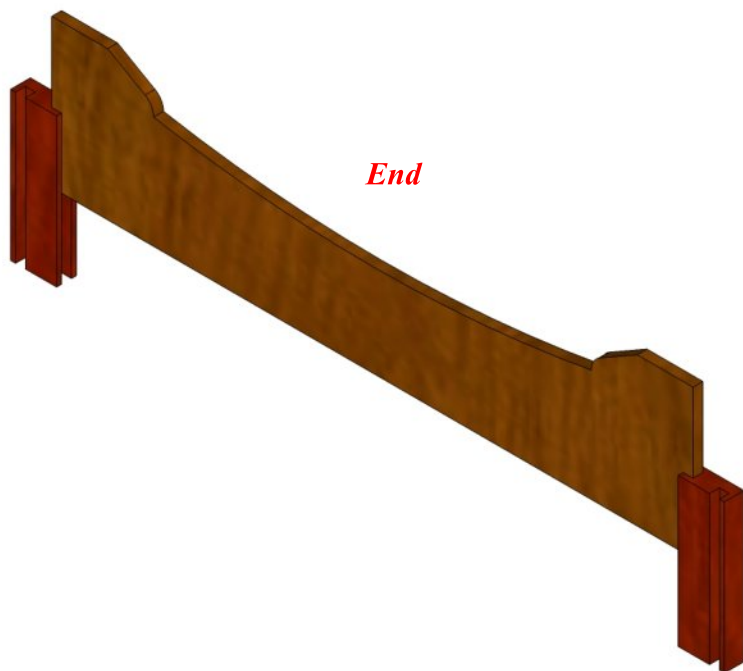

**NOTE**

Insert the **Ends** into the grooves on the 1 1/2-inch side (edge) of the **Posts** as shown at left. Make sure the grooves on the 3 1/2-inch side (faces) of the **Posts** are facing the same direction. Create two assemblies. If desired, you can drive a couple of 1 1/4-inch deck screws through the face of the **Posts** and into the **Ends**. Be sure to drill countersunk pilot holes.

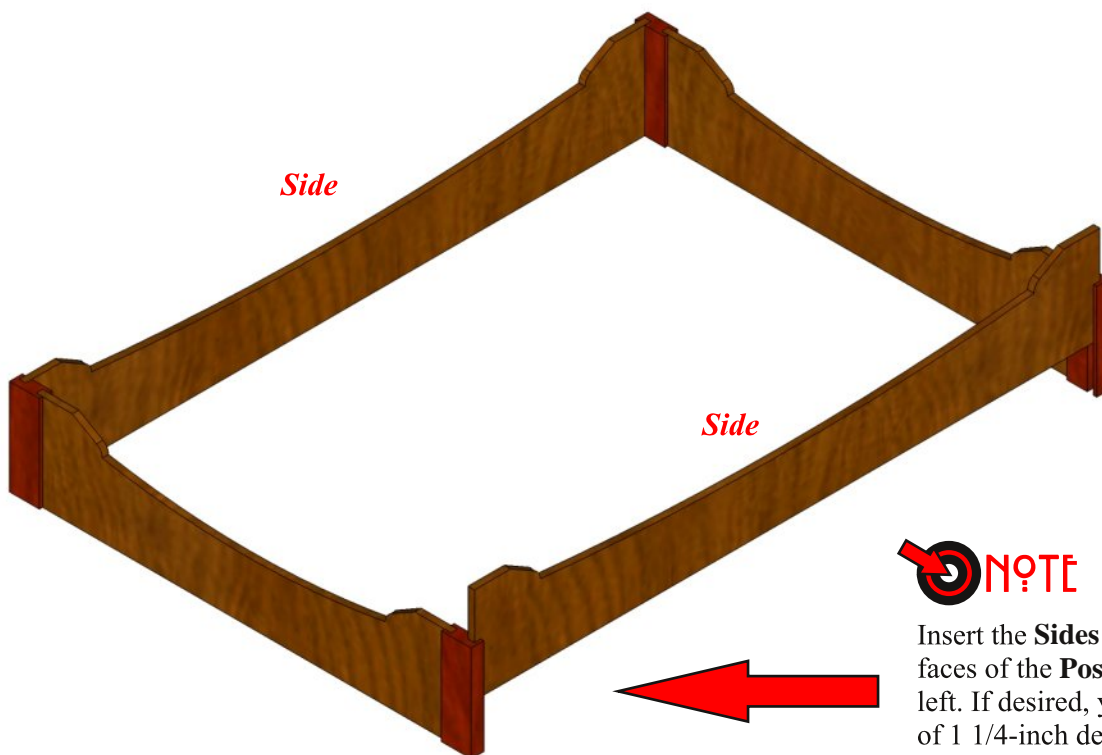

**NOTE**

Insert the **Sides** into the grooves on the faces of the **Posts** as shown at above left. If desired, you can drive a couple of 1 1/4-inch deck screws through the face of the **Posts** and into the **Ends**. Be sure to drill countersunk pilot holes.



# K CUTTING DIAGRAM

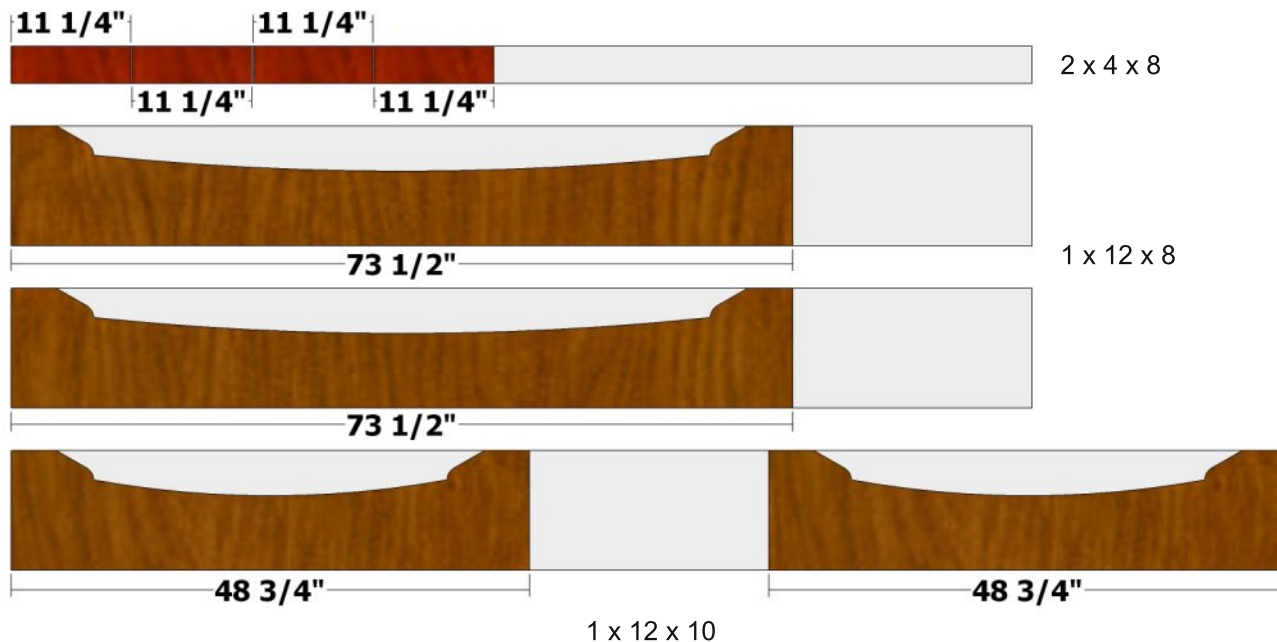

**PARTS**

Posts (4) - 1 1/2 x 3 1/2 x 11 1/4\*  
 Ends (2) - 3/4 x 11 1/4 x 73 1/2  
 Sides (2) - 3/4 x 11 1/4 x 48 3/4  
 \*adjust as desired

All parts are listed in actual dimensions. Refer to the Cutting Diagram on the last page of this plan as a guide for determining the specific board from which to cut the parts.

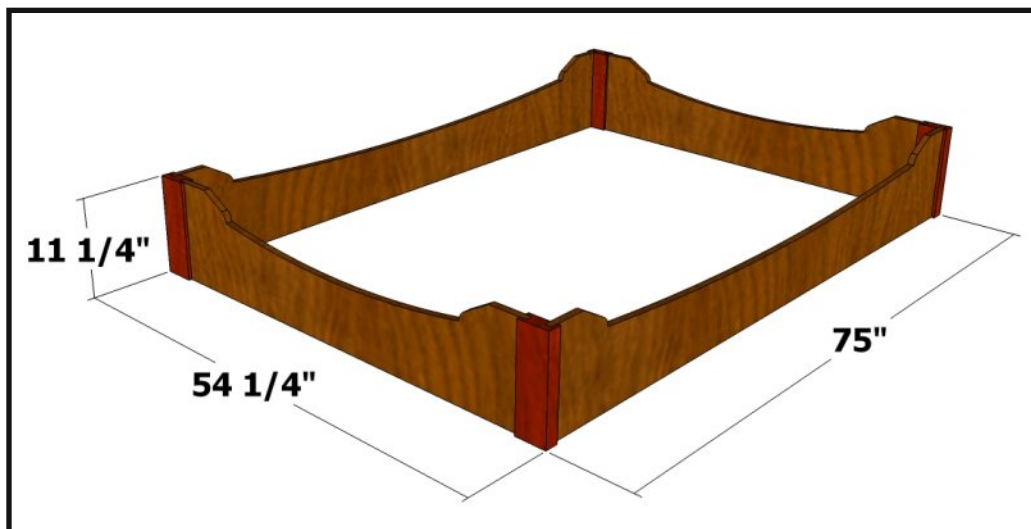

Follow ALL SAFETY GUIDELINES AND RECOMMENDATIONS provided by the manufacturers of your tools, and any chemicals such as glue and finishes you use in this project. YOU are responsible for your safety, so use common sense when working in the shop!